



# IRIS

ALASTOR



WALL SCNCE



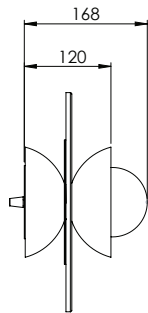
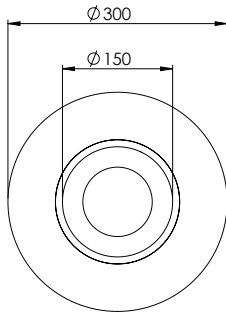

## TECHNICAL DATA

### ALASTOR WALL SCONCE

#### DIMENSIONS

**Overall**  
(Dia) 300mm x (H) 120mm

#### WEIGHT

3.5kg

#### MOUNTING

Wall Mounted  
Hardwired

#### IP RATING

IP20



IRIS

#### MATERIALS

Metal + Metal Mesh + Glass

#### COLOURS

Gold / Brass / Nickel / Rose Gold  
/ Copper / Black / White  
Custom colours available on request

#### FINISHES

**Metal**  
Brushed / Satin

#### Shade

Clear / Frosted / Opal / Tinted / Textured

#### LIGHT SOURCE

E27 LED Lamp (included)  
2700K / 8W / 700lm  
Phase Cut Dimmable

Designed By Tegan Gardner

